

Activation Instructions:

- 1) Activate dispenser by unscrewing reservoir one half turn (180 degrees counter clockwise). (Activation opens the dispenser, so ants can feed on bait.) Unscrewing reservoir too far can result in bait leakage.
- 2) Tighten the safety lock screw to lock the reservoir in place and prevent child tampering.

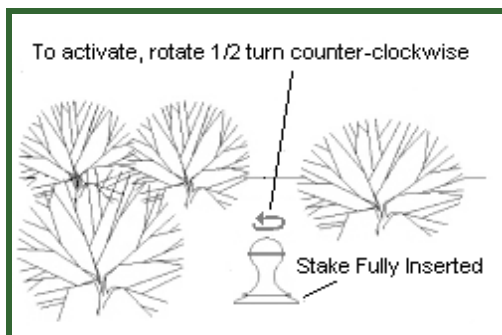

Other Instructions:

- 1) After colony elimination or control, leave dispensers in place to prevent re-infestation. The dispensers are designed to hold and deliver bait for extended periods, but should be emptied, flushed-out, and refilled with fresh bait every few months. Additional bait refills are sold separately.
- 2) Avoid tilting or jarring dispensers once they are activated, — this disturbs the metering action and can cause the bait to leak.
- 3) **Important:** Do not apply insecticides or other baits while using your **AntPro system**, although these products kill visible insects quickly, they serve to alert other colony members to bud “divide” the nest and reproduce more rapidly. The foragers are killed before they have an opportunity to return to their nest and feed their queens, nursery and other colony members.

Gourmet Liquid Ant Bait

Contains Disodium Octaborate Tetrahydrate 1% as its active ingredient. It is specially formulated to retard the development of mold and can be diluted with distilled water or a food grade liquid 1 to 1 making a .5% active ingredient bait to optimize its cost effectiveness and palatability to an exceptionally wide variety of ant species. “*Tramp Ants”, which are the ants we are most concerned with controlling tend to make very large colonies and have a high demand for food sources high in sugar. Most of the time this demand for sugar is met by taking the excretions of plant-sucking bugs like aphids, scales and mealybugs in exchange for protection from predatory insects. This liquid is referred to as “Honeydew”. **Gourmet Ant Bait®** is scientifically formulated to mimic this natural ant food, additionally it contains a patented attractant “UNI-TRACT®”. “UNI-TRACT” increase the feeding of Carpenter Ants, Ghost Ants, Argentine Ants, Crazy Ants, Imported Fire Ants, Pharaoh Ants, White-footed Ants, Big Headed ants, roaches and numerous other insects.

AntPro® and Gourmet, are certified USDA, National Organic Program (NOP) food crop compliant.



*Tramp ant is a title applied to several invasive ant families with proven ability to hitchhike with human travel and establish colonies in new regions all around the globe. Argentine, ghost, fire, White Footed, Long legged and crazy ants are just a few of this group's members.



KM AntPro

Placement Strategy & Installation Guide

One of the first considerations when utilizing the **AntPro System**, is where to locate the dispensers and how many are required to do the job. Whether you are eliminating insects that are invading a home or office complex, a lawn or garden area, or infesting agricultural acreage, there are reliable guidelines to follow for successful and economical control and monitoring.

It's important to remember that only a selected group of ant workers from most ant colonies are charged with the responsibility of providing food for its members. They perform this task by initially foraging at random. Only after these ants have found an attractive food source do they mark and create positive pheromone trails, chemically marked highways, from the food source home to their colony. This means the initial randomly foraging ant

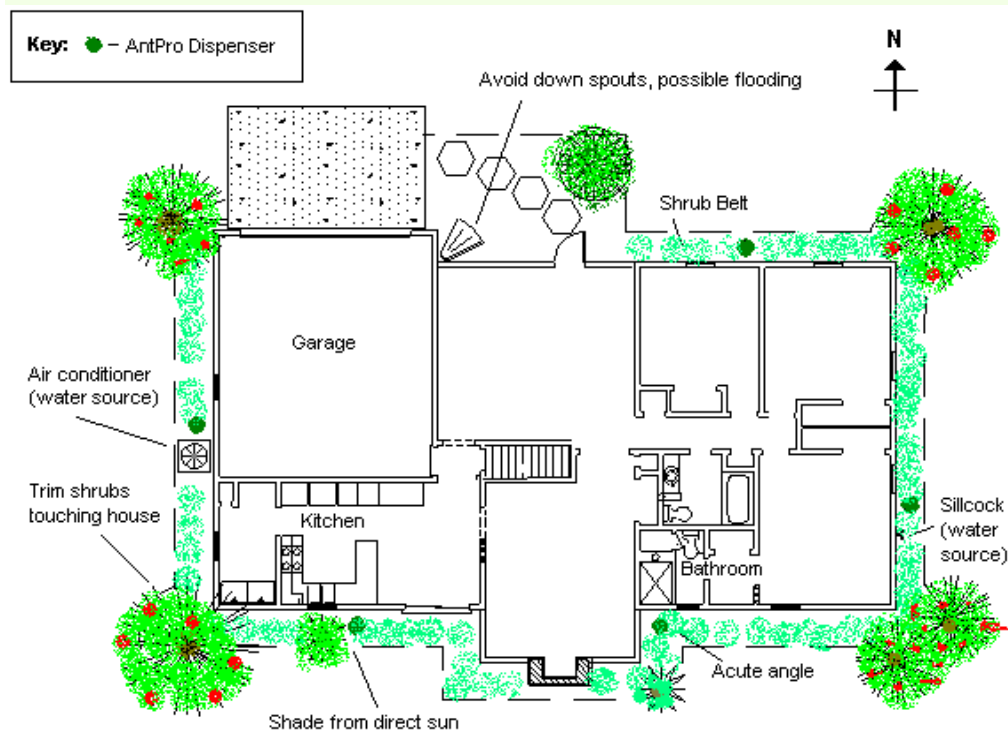

24/7 control and monitoring around homes and other structures

1) Install at least one **AntPro®** dispenser on each side of the structure, giving consideration to its size, and the number of different connecting walls. For a small home or building consisting of approximately 1500 sq. ft., place one unit at each side. The following are additional **AntPro** dispenser placement considerations:

- a) Key areas such as acute joining wall angles where insects converge.
- b) Place a unit when possible by the air conditioner condenser water overflow outlet. Water is always primary insect attractant

- c) North-side of structures with predominate shade and moisture.
 - d) Where ants are seen trailing.
 - e) Most important, do not put units directly over nests; place dispensers when possible at least **5 ft. away or farther** from the nest. **Do not disturb nests, and do not spray the area with insecticides.**
 - f) Avoid locations where substantial water run-off will occur.
- 2) Guidelines for unit placement around buildings. The following averaged measurements are for potential invasion areas (ground floor, only).

- a) 0 – 1,900 square feet 4 units to 6*
- b) 1,901 – 2,999 “ “ 6 units to 8*
- c) 3,000 - 5,000+ “ “ 8 units to 12*

* “Exotic invasive ants” including White-footed, Big-headed, Argentine ants, Caribbean Crazy ants, Long legged ants & Yellow Crazy ants,

Lawn, garden and balance of property

For full property protection, place additional **AntPro** dispensers spaced around the perimeter of property. Depending on the ant species, each **AntPro** dispenser covers an area with a minimum radius of 30 feet (60 ft. spacing between units for Argentine and white-footed ants) to a radius of 75 feet (150 ft. spacing of un-obstructed ground between units for imported fire ants). Locate units where ants are most active; and preferably, in shrub or tree belts so as not to interfere with lawn maintenance. **Deploy dispensers in shade, avoid locations with full sun exposure**, and where substantial water run-off will occur. **Note:** If a dispenser is submerged due to unusually heavy rain, allow the water to recede. It will not lose its bait content and foraging insects will reactivate it.

Baiting strategy

1) **AntPro®** provides ants and other insects with long term continuous access to food. Initially, if you have a large infestation of ants, they will consume the bait contents at a faster rate until their population is reduced and the colony destroyed (most ant species). Keep in mind when these populations are destroyed other ants will eventually move into the uninhabited area. Once the colony is eliminated, keep the **AntPro** dispensers activated and in place as **sentinels** to prevent re-infestation.

2) If you have a particularly difficult ant problem, first attempt to identify the ants and learn more about them. With most ant species, you will find that simply following our installation and placement instructions, the problem will be resolved. There are some non-indigenous and highly invasive ant species that have and are creating serious environmental and economic problems in areas of the United States and worldwide. The Argentine ant, red imported fire ant, long-legged ant, big headed ant, Caribbean crazy ant and white-footed ants are such ants. You are welcome to visit our website to learn more about ants and control solutions. You can also write or contact us by phone. **Please note:** If you choose to send us ant samples for identification, please send a minimum of five ants safely packed so as not to be crushed. If the ants vary in size, send samples of each. Please make certain any insects sent through the mail are dead. Freezing them prior to mailing will suffice.

KM AntPro LLC

Ofc: (941)445-4252

P.O. Box 967, Nokomis, FL 34275

Fax: (941) 445-4253

Installation & Operating Instructions

A-1

General: (Start Here)

When AntPro bait dispensers filled with Gourmet Liquid Ant Bait are deployed, they provide a safe and highly effective means to destroy ants and their colonies. **AntPro** works when foraging ants carry the bait back to feed and kill the queens and other colony members. Once colonies are eliminated, keep **AntPro** filled with Gourmet Liquid Ant bait to provide 24/7 property monitoring and protection from re-infestation.

Filling Instructions:

- 1) Turn dispenser upside down, then unscrew and remove base.
- 2) Fill dispenser through filler hole with at least **16 oz. of liquid ant bait**. (Max capacity is 19 oz.)
- 3) Re-attach base to reservoir, then tighten snugly, so bait doesn't leak when dispenser is turned right side up.
- 4) Insert anchor stake into square hole in underside of base. Apply firm pressure until stake snaps into place.

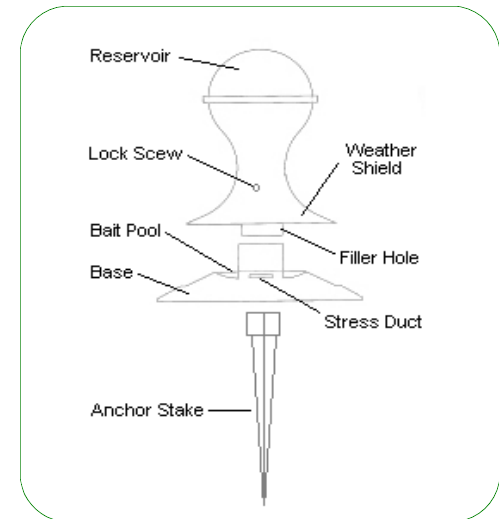

Ground installation Instructions:

- 1) Place dispensers on level ground, away from direct sunlight, preferably in a shrub belt around the outside of your home. (Avoid using ant bait indoors, because it attracts ants into your home. Ants living inside, will find bait even when it's located outside.)
- 2) Using a screwdriver, make a small pilot hole in the ground.
- 3) Insert stake, with dispenser attached, into pilot hole. Apply even downward pressure to dispenser, until stake is firmly anchored in ground. (When the stake is fully inserted, the dispenser base should sit flush on the ground. If not, make the pilot hole deeper.)
- 4) For best results, place at least one dispenser on each side of your home.
- 5) See reverse side for area placement information.

